

# MERKEL AQUASTAR HELL 4315

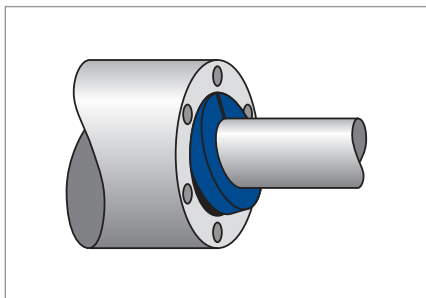

## OPERATING CONDITIONS

Operating pressure	Temperature	Speed	pH value
16 bar	-30 ... +100 °C	6 m/s	6 ... 9

### Media

Cold and warm water, air, etc.

## PRODUCT DESCRIPTION

Made from fine DIAPLEX® cotton thread braided rotary pump packing impregnated with a universally resistant mineral grease.

For all simple rotary applications with drinking water, sea water and lightly acidic and alkaline sewage.

## PRODUCT ADVANTAGES

- Cost-effective for simple applications
- Prevents overheating during critical running-in phase
- Protects the shaft.

## APPLICATION

Rotary pumps.